

model: TL390x-LED

LIBRA SMD

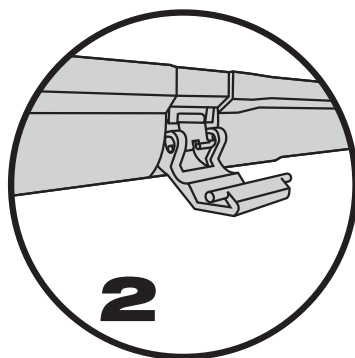

4x TL3901A-LED20W  
8x TL3902A-LED40W  
14x TL3903A-LED60W

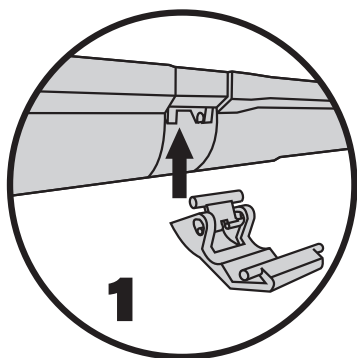
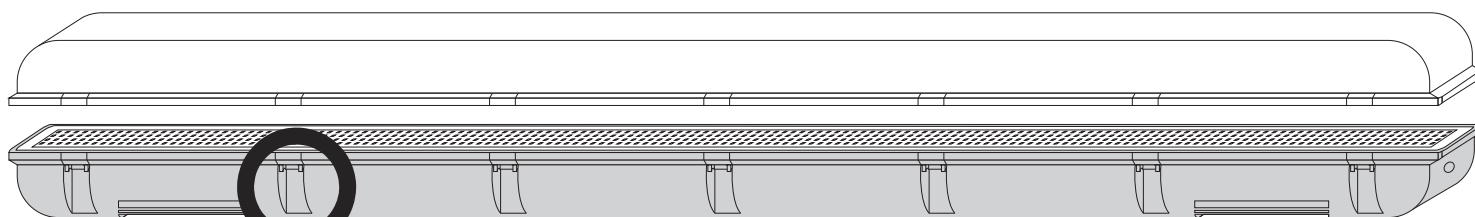
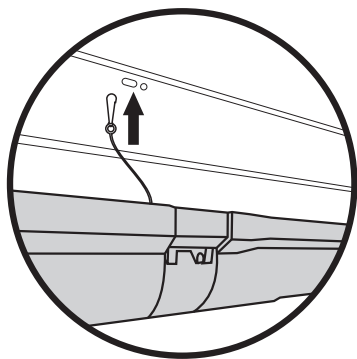
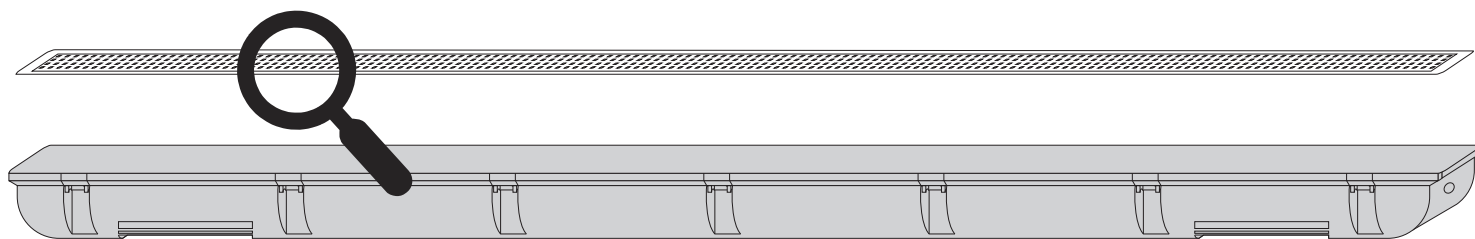
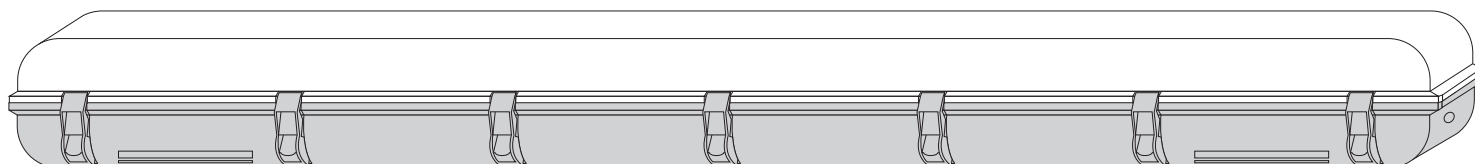

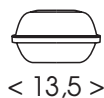
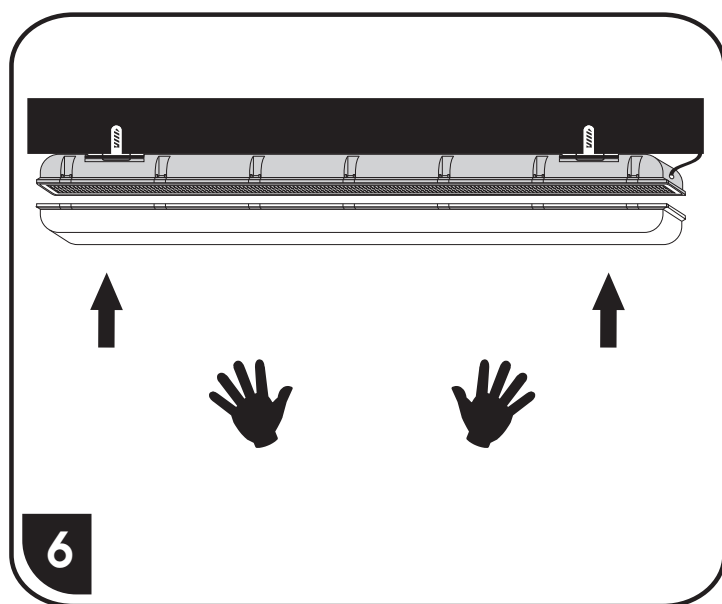
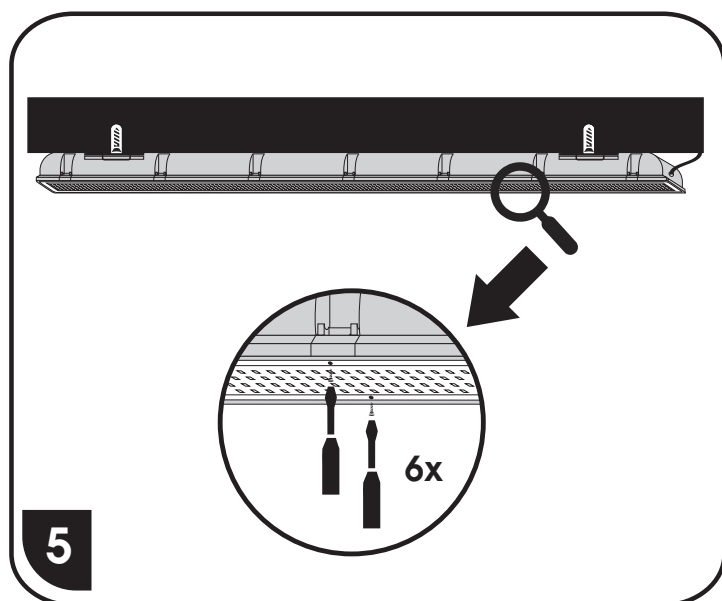
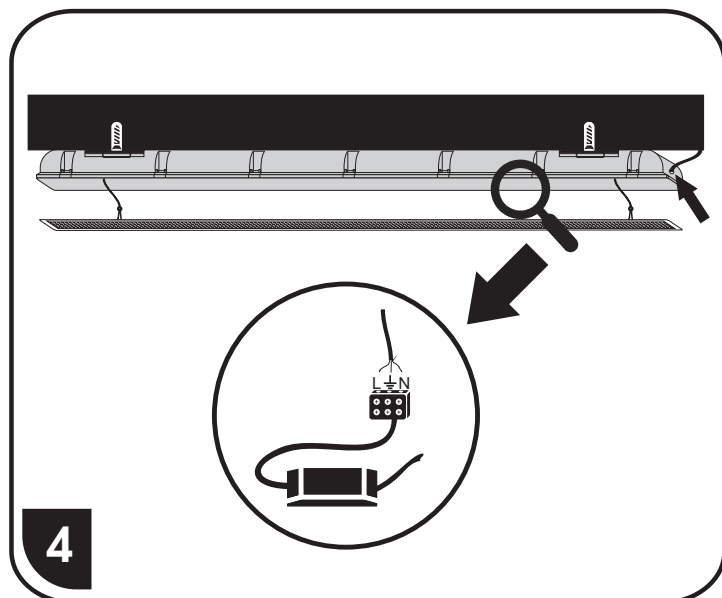
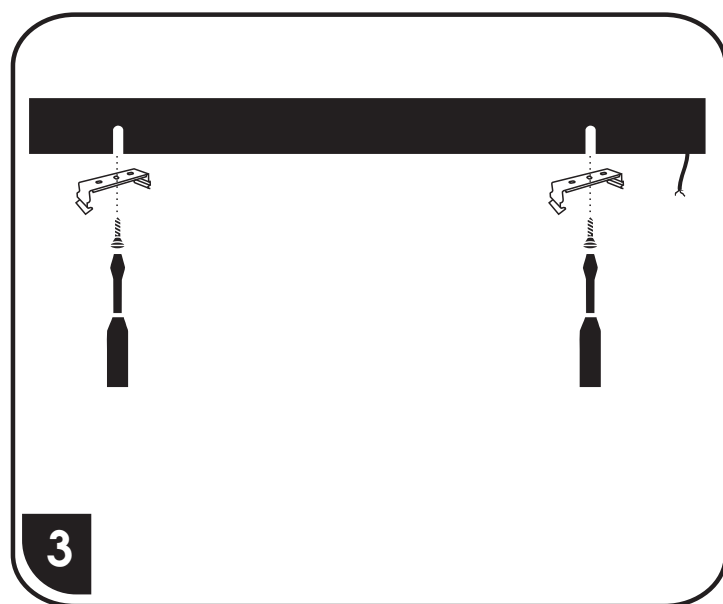
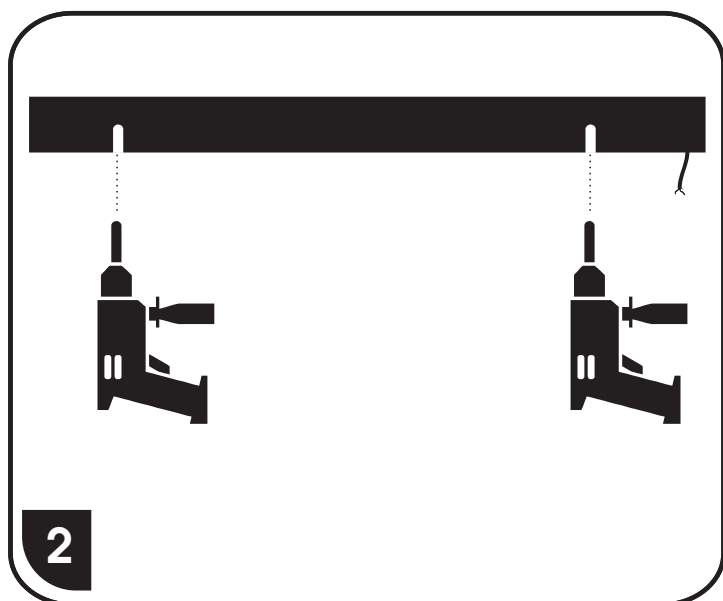
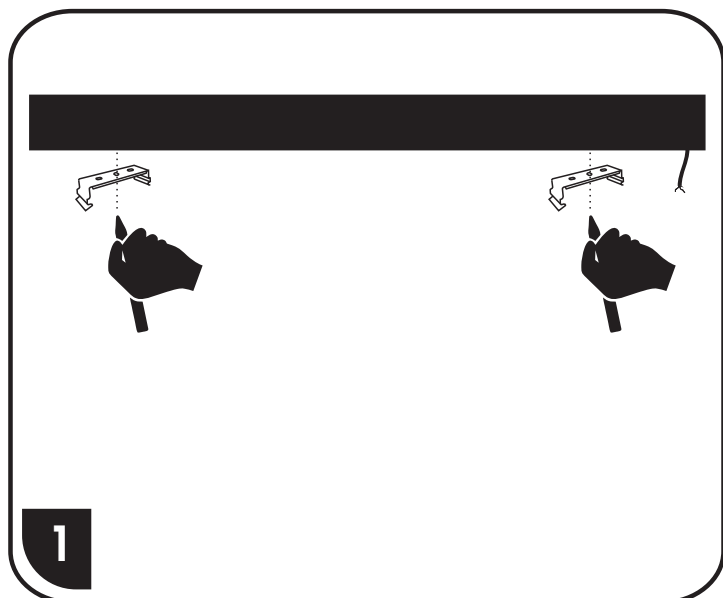

> 100 <

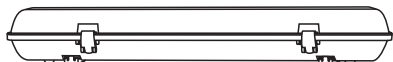

TL3901A-LED20W < 67,0 >  
 TL3902A-LED40W < 127,5 >  
 TL3903A-LED60W < 157,5 >



~230V



max.  
20W

max.  
40W

max.  
60W



IP65

30000h

4100K

Ra  
≥80

